

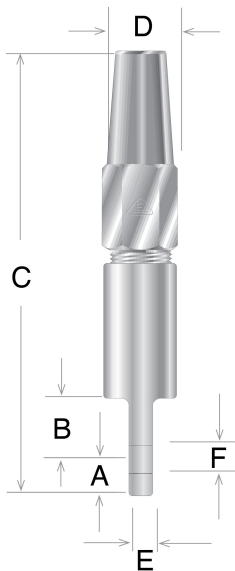

Eye Socket Fitting for Kevlar Extruded Jacket Rope



Electroline synthetic rope fittings for Kevlar ropes with extruded jackets excel in meeting the need for a quick, reliable end termination. The fittings perform on polyurethane, Nylon II, and Hytrel jacket materials for ropes with the following construction: standard wire rope, contra-helical, parallel, and electro-mechanical. This fitting features a clevis (fork/jaw) connection and a swageless rope termination, allowing it to be quickly installed in the field without special tools.

- Available for ropes 3/16 to 3/4" in size.
- Machined from aluminum to provide lightweight strength.

Specifications

Termination Type	Swageless
Connector Type	Eye
Jacket Material	Hytrel, Nylon II, Polyurethane
Jacket Type	Extruded
Rope Material	Kevlar Rope
Material	Aluminum

Available Products

Rope Size (In)	Part No.	Dim A	Dim B	Dim C	Dim D	Dim E	Dim F
3/16	KA-218	1/2	13/16	4-15/16	15/16	23/64	25/64
1/4	KA-225	19/32	27/32	6	1-1/16	23/64	29/64
5/16	KA-231	21/32	31/32	7-9/16	1-3/16	27/64	33/64
3/8	KA-237	3/4	1-1/16	8-1/2	1-3/8	27/64	41/64
7/16	KA-243	27/32	1-1/8	11	1-9/16	31/64	45/64
1/2	KA-250	27/32	1-1/8	11-1/8	1-3/4	31/64	45/64
9/16	KA-256	1-3/32	1-3/8	12-3/4	2	21/32	61/64
5/8	KA-262	1-11/32	1-19/32	14-5/8	2-3/8	23/32	1-9/64
3/4	KA-275	1-1/2	1-13/16	16-5/16	2-5/8	25/32	1-17/64